



Phil Kent, Orchestra Director- Laura Fallon, Associate Director  
401 Reed Lane - Lexington, Kentucky 40503 - 859.381.3474  
[www.lafayetteorchestra.org](http://www.lafayetteorchestra.org) - [lho@mail.com](mailto:lho@mail.com)

Dear Future LHS Students and Parents:

I'm sure everyone is ready for Spring Break and some time to enjoy a little down time with family and friends. I am very excited to meet each of you and welcome you to the Lafayette High School Orchestra Family. I would like to give you a look into my teaching background and also a bit of information regarding the orchestra department's vision so that you feel welcome and excited about your new experience.

I've been an orchestra teacher for nine years where I've taught grades 4<sup>th</sup> - 12<sup>th</sup> and I will be completing my fourth year on staff here at Lafayette and my eleventh year in the string education field. Teaching strings is my passion and it's more than a job, it's my life.

Our vision of the Lafayette HS Orchestra is to develop in each student an appreciation of the art of music as a part of general culture; to teach techniques of musical expression; to discover and develop the talents of students in all styles of music; to develop knowledge and skills in listening, reading and performing all styles of music. Quality music literature is the curriculum of music education. We must strive to bring our students to a level of group and individual proficiency so that they can experience original works by the great composers of the past and present. The opportunities for a student to be a part of this recreation of intent are an important development of a student's worldly understanding.

Along with a worldly understanding, music offers experiences that promote training of the heart and head. Self-confidence, teamwork, development of fine motor skills, and the use of spatial-temporal reasoning produces a well-rounded student atoned to a strong work ethic. An education using the musical arts develops high levels of achievement in reading, reading comprehension, and language developments. An opportunity for student leadership within a performance-based organization provides real-world experience in problem solving, inter- and intra-personal relationships, role model leadership, decision-making, critical thinking, and depending on others.

Please feel free to contact me with any questions or check out our orchestra website and I would love to know about any recitals or other performances that includes our orchestra family! Thank you and I'm looking forward to a great year!

Yours in music education,

A handwritten signature in black ink that reads "Phil Kent". The signature is written in a cursive style with a large, prominent "P" and "K".

Phil Kent

Director of the Lafayette Orchestra Dept.

[phil.kent@fayette.kyschools.us](mailto:phil.kent@fayette.kyschools.us)



Phil Kent, Orchestra Director- Laura Fallon, Associate Director  
401 Reed Lane - Lexington, Kentucky 40503 - 859.381.3474  
www.lafayetteorchestra.org - lhsomail.com



## Save the date...

**March 23<sup>rd</sup> - March 27<sup>th</sup>**

### **Director Visits To Middle Schools**

1. Pass Out Packets
2. Pass Out Audition Music (Level 1-4)

**Thursday, April 10<sup>th</sup>**

### **Freshman Packets are Due to Orchestra Teacher**

1. Student/Family Information Sheet
2. Volunteer Form
3. Audition Registration Form

**Wednesday, April 22<sup>th</sup>**

**Viola/Cello/Bass Auditions @ LHS Orchestra Room,  
4:00-6:00pm**

**Thursday, April 23<sup>th</sup>**

**Violin Auditions @ LHS Orchestra Room, 4:00-8:00pm**

**Tuesday, May 19<sup>th</sup>**

**LHSO Spring Concert, Singletary Center, 7:30pm**

**July 20<sup>th</sup> - July 23<sup>rd</sup>**

**Freshman Camp @ LHS, 9:00-noon each day**

**Thursday, July 23<sup>rd</sup> Concert after lunch**



Phil Kent, Orchestra Director- Laura Fallon, Associate Director  
401 Reed Lane – Lexington, Kentucky 40503 - 859.381.3474  
www.lafayetteorchestra.org – lhso@mail.com

## **Orchestra Level 1-4 Summaries**

**Level one** is for the typical student who needs to continue learning skills at the normal pace. In this class we work on intonation in multiple keys, shifting and reading in 3<sup>rd</sup> position (4<sup>th</sup> for cello, 5<sup>th</sup> for bass) and foundations of vibrato. Students have a working knowledge of correct right and left hand shape and are working to refine their posture and technique.

**Level two** is for the student who is currently working at a higher level than most in his or her grade. In this class we work in higher positions and more complex key signatures. Students at this level need to already be comfortable in 3<sup>rd</sup> position for violins and violas with a fundamental understanding of 2<sup>nd</sup>, 4<sup>th</sup> and 5<sup>th</sup> position. These students have a relaxed left hand position with a polished vibrato and flexibility in right wrist and fingers allowing for more advanced bow techniques such as spiccato and legato.

**Level three** is for the advanced musician, typically someone who is or will be in CKYO's top orchestra. In this orchestra we read in all positions and in all keys. Scale tests are three octaves for all but the basses. These students display the versatility in left and right hand technique needed to perform many styles of music.

**Level four** is for the VERY advanced student with fluid technique and mastery of all keys and positions. These students are looking to express and enhance their musicality through chamber rehearsal and performance. These students have an established practice routine allowing for in class rehearsal, not individual practice. Most of these students are All State caliber musicians and after school rehearsal/sectionals will be required.



Phil Kent, Orchestra Director- Laura Fallon, Associate Director  
 401 Reed Lane – Lexington, Kentucky 40503 - 859.381.3474  
[www.lafayetteorchestra.org](http://www.lafayetteorchestra.org) – [lhso@mail.com](mailto:lhso@mail.com)

### Audition Pre-Registration Form



Auditions for LHSO will be held from **3:45-6:00PM** on **Wednesday, April 22<sup>nd</sup>** for **Viola, Cello and Bass** and **Thursday, April 23<sup>rd</sup>** for **Violins**. Auditions will take place at Lafayette High School in the Music Department. Lafayette High School can be tricky to navigate. Please see the enclosed map for directions. If you are unable to make these audition dates, please notify me at [phil.kent@fayette.kyschools.us](mailto:phil.kent@fayette.kyschools.us) at your earliest convenience. Only those students wishing to audition for level 2 or higher will be assigned an audition time. Those students auditioning for level 1 will play for the director when they visit your school the week of April 20<sup>th</sup> – 24<sup>th</sup>. Level 1 auditions may be recorded and sent to Mr. Kenty. **Please submit this to your orchestra teacher by April 11<sup>th</sup>. The final schedule will be post on the orchestra website.**

Name: \_\_\_\_\_

Instrument: \_\_\_\_\_

Middle School: \_\_\_\_\_

Do you have a specific time preference? Is so what time? \_\_\_\_\_

Level 1    2    3    4    (circle one) Please review the "Orchestra Level 1-4 Summaries"

Music found online: [www.lafayetteorchestra.org](http://www.lafayetteorchestra.org)



Phil Kent, Orchestra Director- Laura Fallon, Associate Director  
401 Reed Lane - Lexington, Kentucky 40503 - 859.381.3474  
[www.lafayetteorchestra.org](http://www.lafayetteorchestra.org) - [lhsomail.com](mailto:lhsomail.com)

On behalf of the Lafayette Orchestra Boosters, I would like to welcome all parents and supporters of the Lafayette Orchestra.

The Lafayette Orchestra Boosters exists solely to support the students in this program in order for them to receive the full benefit of one of the best orchestral educations in Kentucky. The Boosters allow Mr. Kent and Ms. Fallon to focus on teaching our children, while we focus on the logistics of running this very large orchestra program.

The Lafayette Orchestra Boosters host many activities and socials in order to encourage unity and acceptance among the orchestra as a String Family. This begins in July of each year during Freshman String Camp. Incoming freshman have the ability to meet and play alongside upperclassmen, thus improving their musical talents, as well as having familiar faces waiting for them on their first day of high school.

The Lafayette Orchestra Boosters also support the music programs throughout the school year. Fees and fundraising proceeds are used to support our students participating in KMEA assessments, All State Auditions, and the annual concert held at the Singletary Center for the Arts at the University of Kentucky. The Boosters also fund awards given to outstanding students, snacks for after school rehearsals, and more than 100 hours of guest instructor and clinician time. Our students not only learn from Mr. Kent and Ms. Fallon, but also have the opportunity to receive instruction from some of the great teachers in central Kentucky.

There are many opportunities to volunteer throughout the school year, most requiring very little time. A new Lafayette Orchestra Booster Board is elected each year in May at the annual Orchestra Awards Banquet. We invite parents to participate in all of the Booster activities. Information regarding the orchestra program can be found at [lafayetteorchestra.org](http://lafayetteorchestra.org). The Boosters organization can be reached at [lhsomail.com](mailto:lhsomail.com) should you have any questions, comments, or suggestions. All comments are welcome.

The Orchestra Booster Board needs YOU! Please fill out the Volunteer form and let us know how we can work together.

Susan Bossert

President 2014-2015



Phil Kent, Orchestra Director- Laura Fallon, Associate Director  
 401 Reed Lane - Lexington, Kentucky 40503 - 859.381.3474  
 www.lafayetteorchestra.org - lhso@mail.com

## Parent Volunteer Form

<http://www.lafayetteorchestra.org/volunteer-opportunities.html>

Parent Name \_\_\_\_\_ Home Phone ( ) \_\_\_\_\_

Work Phone ( ) \_\_\_\_\_ Cell Phone ( ) \_\_\_\_\_

Email \_\_\_\_\_ Email \_\_\_\_\_

Occupation/Skills \_\_\_\_\_

Preferred way to contact: Home Phone Work Phone Cell Phone Text Email

**Volunteer Interests (circle)**

- All-State Chaperone
- Banquet
- Booster
- Chaperone Out of Town trips
- Contact Sponsors
- Create Publicity Flyers
- Dress Fitting/Alterations/Hemming
- Graphic Design
- Master of Ceremonies/Public Speaking
- Monitor for local concerts/contests
- Concert Usher
- Concert Volunteer
- Music Library Help
- Music Teacher
- Post Flyers at LHS/Business/Church
- Provide Food/Drink
- Serve Food
- Set-up/Take-Down
- Take Photos
- Website
- Word Processing/Data Entry
- Writing Grants
- Transport small student groups during school hours
- Transport small student groups after school hours



Phil Kent, Orchestra Director- Laura Fallon, Associate Director  
 401 Reed Lane - Lexington, Kentucky 40503 - 859.381.3474  
 www.lafayetteorchestra.org - lhso@mail.com

## Student Demographic Information

Name: First \_\_\_\_\_ Middle \_\_\_\_\_ Last \_\_\_\_\_

Street Address \_\_\_\_\_ Lexington, KY \_\_\_\_\_

Home Phone ( ) \_\_\_\_\_ Cell Phone ( ) \_\_\_\_\_ Carrier\* \_\_\_\_\_

Email \_\_\_\_\_ Grade 2013-2014 \_\_\_\_\_ Sex \_\_\_\_\_ Birthdate \_\_\_\_\_

Instrument \_\_\_\_\_ Private Teacher \_\_\_\_\_ T-Shirt YL S M L XL XXL XXXL

Personal Instrument \_\_\_\_\_ Brand \_\_\_\_\_ Serial Number \_\_\_\_\_

Parent Name (1) \_\_\_\_\_ Home Phone( ) \_\_\_\_\_

Street Address \_\_\_\_\_ Lexington, KY \_\_\_\_\_

Work Phone ( ) \_\_\_\_\_ Cell Phone ( ) \_\_\_\_\_ Carrier\* \_\_\_\_\_

Email \_\_\_\_\_ Email \_\_\_\_\_

Occupation/Skills \_\_\_\_\_

Preferred way to contact: Home Phone Work Phone Cell Phone Text Email

Parent Name (2) \_\_\_\_\_ Home Phone( ) \_\_\_\_\_

Street Address \_\_\_\_\_ Lexington, KY \_\_\_\_\_

Work Phone ( ) \_\_\_\_\_ Cell Phone ( ) \_\_\_\_\_ Carrier\* \_\_\_\_\_

Email \_\_\_\_\_ Email \_\_\_\_\_

Occupation/Skills \_\_\_\_\_

Preferred way to contact: Home Phone Work Phone Cell Phone Text Email

\*Please provide cell phone carrier if you would like to receive text messages for Orchestra information. There is no charge from the Lafayette Orchestra.

# Orchestra Room Location and Parking

**ORCHESTRA ROOM #623**

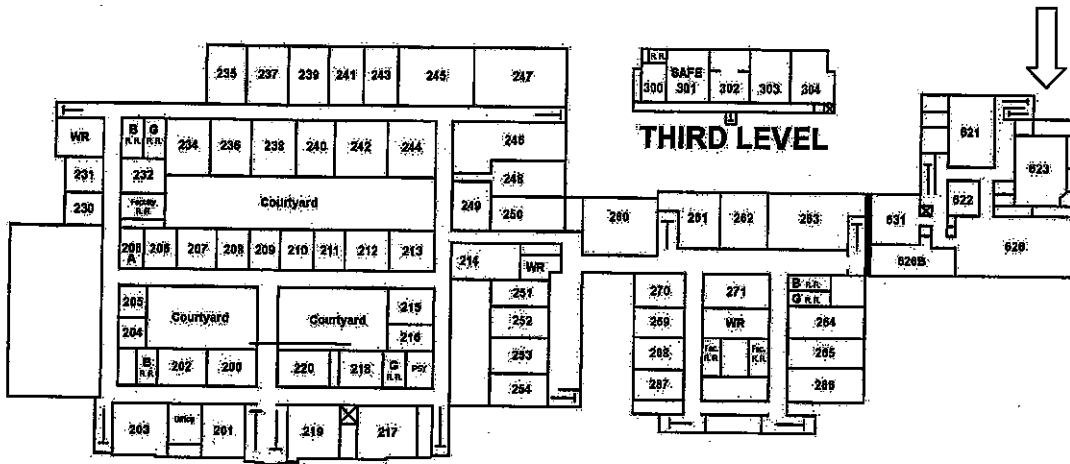

**SECOND LEVEL**

**SPRINGHILL DRIVE**



Softball Field

Louie Mac Building

**PARKING Lot**

**ORCHESTRA ENTRANCE ROOM ENTRANCE**

*-blue double doors -up the stairs*

BUS LOADING AREA

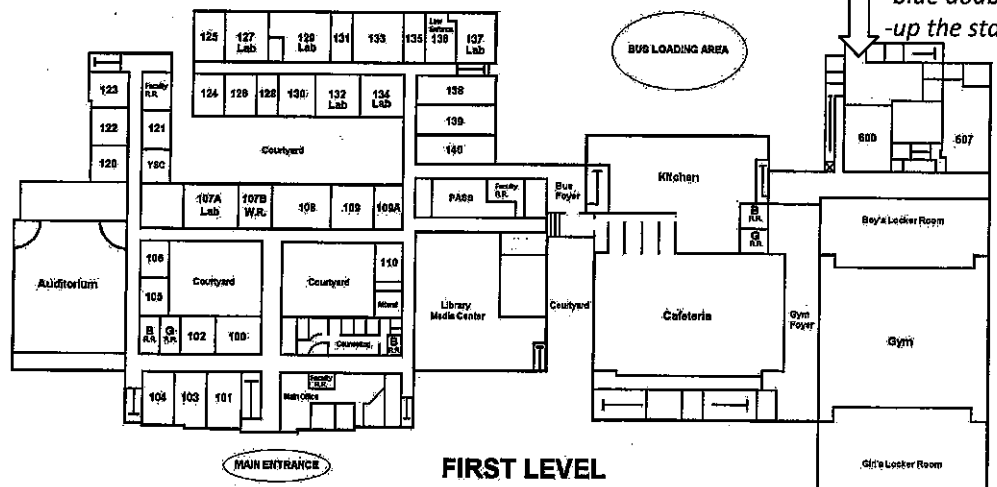

**FIRST LEVEL**

MAIN ENTRANCE

**REED LANE**

