



Phil Kent, Orchestra Director- Laura Fallon, Associate Director  
401 Reed Lane – Lexington, Kentucky 40503 - 859.381.3474  
www.lafayetteorchestra.org – lhso@mail.com

Dear Future LHS Students and Parents:

I'm sure everyone is ready for Spring Break and some time to enjoy a little down time with family and friends. I am very excited to meet each of you and welcome you to the Lafayette High School Orchestra Family. I would like to give you a look into my teaching background and also a bit of information regarding the orchestra department's vision so that you feel welcome and excited about your new experience.

I've been an orchestra teacher for nine years where I've taught grades 4<sup>th</sup> – 12<sup>th</sup> and I will be completing my fourth year on staff here at Lafayette and my eleventh year in the string education field. Teaching strings is my passion and it's more than a job, it's my life.

Our vision of the Lafayette HS Orchestra is to develop in each student an appreciation of the art of music as a part of general culture; to teach techniques of musical expression; to discover and develop the talents of students in all styles of music; to develop knowledge and skills in listening, reading and performing all styles of music. Quality music literature is the curriculum of music education. We must strive to bring our students to a level of group and individual proficiency so that they can experience original works by the great composers of the past and present. The opportunities for a student to be a part of this recreation of intent are an important development of a student's worldly understanding.

Along with a worldly understanding, music offers experiences that promote training of the heart and head. Self-confidence, teamwork, development of fine motor skills, and the use of spatial-temporal reasoning produces a well-rounded student attuned to a strong work ethic. An education using the musical arts develops high levels of achievement in reading, reading comprehension, and language developments. An opportunity for student leadership within a performance-based organization provides real-world experience in problem solving, inter- and intra-personal relationships, role model leadership, decision-making, critical thinking, and depending on others.

Please feel free to contact me with any questions or check out our orchestra website and I would love to know about any recitals or other performances that includes our orchestra family! Thank you and I'm looking forward to a great year!

Yours in music education,

Phil Kent  
Director of the Lafayette Orchestra Dept.  
phil.kent@fayette.kyschools.us



Phil Kent, Orchestra Director- Laura Fallon, Associate Director  
401 Reed Lane – Lexington, Kentucky 40503 - 859.381.3474  
[www.lafayetteorchestra.org](http://www.lafayetteorchestra.org) – [lhso@mail.com](mailto:lhso@mail.com)

### **Welcome from the Lafayette Orchestra Boosters!**

Our goal is to create a family atmosphere so that each child can grow and flourish on their string journey. We provide a variety of support and aid to the Directors and Orchestra Members. Through tremendous parental support, we are able to assist in dress fittings, logo apparel sales, fundraising, concert hospitality, Freshman String Camp and much more. It is our desire to make each and every student feel welcome and accepted. As part of that effort Mr. Kent has implemented a Freshman String Camp so incoming and new orchestra students can know where to go and what to expect. He is also incorporating the feeder middle schools to perform with LHSO many times during the year.

We believe that the key to a successful relationship is communication and have incorporated a web site that will keep orchestra families well informed of upcoming events and dates. Through the Lafayette Orchestra website ([www.lafayetteorchestra.org](http://www.lafayetteorchestra.org)) we are able to communicate with our orchestra families and the Lexington Musical Community.

### **The Orchestra Booster Board needs YOU!**

We have many graduating seniors and their parents leaving us this year. We need Booster Board positions and At Large positions filled. Any amount of time and commitment is needed.

We can't help the Directors or the children without the support and effort of everyone. Even if you work, or have other obligations, your experience and time can help us create a wonderful Orchestra.

Please fill out your Volunteer form and let us know how we can work together.

The easiest way to contact the Booster Organization is to use our email address. We will direct your email to the correct person.

Our Booster email: [lhso@mail.com](mailto:lhso@mail.com)

In closing, on behalf of Mr. Kent, Ms Fallon and the booster board, I invite you to enjoy the high school orchestral experience along with your child.

Sincerely,

Amy Caudill



Phil Kent, Orchestra Director - Laura Fallon, Associate Director  
 401 Reed Lane - Lexington, Kentucky 40503 - 859.381.3474  
 www.lafayetteorchestra.org - lhso@mail.com

## Parent Volunteer Form

<http://www.lafayetteorchestra.org/volunteer-opportunities.html>

Parent Name \_\_\_\_\_ Home Phone (    ) \_\_\_\_\_

Work Phone (    ) \_\_\_\_\_ Cell Phone (    ) \_\_\_\_\_

Email \_\_\_\_\_ Email \_\_\_\_\_

Occupation/Skills \_\_\_\_\_

Preferred way to contact:    Home Phone    Work Phone    Cell Phone    Text    Email

### Volunteer Interests (circle)

- All-State Chaperone
- Banquet
- Booster
- Chaperone Out of Town trips
- Contact Sponsors
- Create Publicity Flyers
- Dress Fitting/Alterations/Hemming
- Graphic Design
- Master of Ceremonies/Public Speaking
- Monitor for local concerts/contests
- Concert Usher
- Concert Volunteer
- Music Library Help
- Music Teacher
- Post Flyers at LHS/Business/Church
- Provide Food/Drink
- Serve Food
- Set-up/Take-Down
- Take Photos
- Website
- Word Processing/Data Entry
- Writing Grants
- Transport small student groups during school hours
- Transport small student groups after school hours



### Student Demographic Information

Name: First \_\_\_\_\_ Middle \_\_\_\_\_ Last \_\_\_\_\_

Street Address \_\_\_\_\_ Lexington, KY \_\_\_\_\_

Home Phone ( ) \_\_\_\_\_ Cell Phone ( ) \_\_\_\_\_ Carrier\* \_\_\_\_\_

Email \_\_\_\_\_ Grade 2013-2014 \_\_\_\_\_ Sex \_\_\_\_\_ Birthdate \_\_\_\_\_

Instrument \_\_\_\_\_ Private Teacher \_\_\_\_\_ T-Shirt YL S M L XL XXL XXXL

Personal Instrument \_\_\_\_\_ Brand \_\_\_\_\_ Serial Number \_\_\_\_\_

Parent Name (1) \_\_\_\_\_ Home Phone( ) \_\_\_\_\_

Street Address \_\_\_\_\_ Lexington, KY \_\_\_\_\_

Work Phone ( ) \_\_\_\_\_ Cell Phone ( ) \_\_\_\_\_ Carrier\* \_\_\_\_\_

Email \_\_\_\_\_ Email \_\_\_\_\_

Occupation/Skills \_\_\_\_\_

Preferred way to contact: Home Phone Work Phone Cell Phone Text Email

Parent Name (2) \_\_\_\_\_ Home Phone( ) \_\_\_\_\_

Street Address \_\_\_\_\_ Lexington, KY \_\_\_\_\_

Work Phone ( ) \_\_\_\_\_ Cell Phone ( ) \_\_\_\_\_ Carrier\* \_\_\_\_\_

Email \_\_\_\_\_ Email \_\_\_\_\_

Occupation/Skills \_\_\_\_\_

Preferred way to contact: Home Phone Work Phone Cell Phone Text Email

\*Please provide cell phone carrier if you would like to receive text messages for Orchestra information. There is no charge from the Lafayette Orchestra.



Phil Kent, Orchestra Director - Laura Fallon, Associate Director  
 401 Reed Lane - Lexington, Kentucky 40503 - 859.381.3474  
 www.lafayetteorchestra.org - lhso@mail.com



# LHSO Orchestra Apparel

Student Name \_\_\_\_\_

Phone: \_\_\_\_\_

School/Orchestra: \_\_\_\_\_

Crewneck: Columbia Blue or Black with musical tree (\$20.00) color: \_\_\_\_\_

YM	YL	YXL	S	M	L	XL	XXL

\$ \_\_\_\_\_

Hoody: Columbia Blue or Black with musical tree (\$25.00) color: \_\_\_\_\_

YM	YL	YXL	S	M	L	XL	3XL + \$4

\$ \_\_\_\_\_

T-Shirts: *Columbia Blue, Black, Red, Royal, Navy, Pink, Dark Green, Gold, Maroon, Cardinal, Orange, Vegas Gold, Kelly, or Purple* with musical tree (\$12.00) color: \_\_\_\_\_

YM	YL	YXL	S	M	L	XL	3XL + \$1

\$ \_\_\_\_\_

Deadline: **Friday, April 11th**

Paper Orders: Make Checks to "Lafayette Orchestra Association"

Check (# \_\_\_\_\_)

**ADD \$3.00 FOR TAXES AND SHIPPING FEES**

**+ \$3.00**

Estimated Delivery is 2-3 weeks. Delivered to LHS Orchestra Room then to each school

TOTAL AMOUNT = \$ \_\_\_\_\_



## Orchestra Level 1-4 Summaries

**Level one** is for the typical student who needs to continue learning skills at the normal pace. In this class we work on intonation in multiple keys, shifting and reading in 3<sup>rd</sup> position (4<sup>th</sup> for cello, 5<sup>th</sup> for bass) and foundations of vibrato. Students have a working knowledge of correct right and left hand shape and are working to refine their posture and technique.

**Level two** is for the student who is currently working at a higher level than most in his or her grade. In this class we work in higher positions and more complex key signatures. Students at this level need to already be comfortable in 3<sup>rd</sup> position for violins and violas with a fundamental understanding of 2<sup>nd</sup>, 4<sup>th</sup> and 5<sup>th</sup> position. These students have a relaxed left hand position with a polished vibrato and flexibility in right wrist and fingers allowing for more advanced bow techniques such as spiccato and legato.

**Level three** is for the advanced musician, typically someone who is or will be in CKYO's top orchestra. In this orchestra we read in all positions and in all keys. Scale tests are three octaves for all but the basses. These students display the versatility in left and right hand technique needed to perform many styles of music.

**Level four** is for the VERY advanced student with fluid technique and mastery of all keys and positions. These students are looking to express and enhance their musicality through chamber rehearsal and performance. These students have an established practice routine allowing for in class rehearsal, not individual practice. Most of these students are All State caliber musicians and after school rehearsal/sectionals will be required.



Phil Kent, Orchestra Director - Laura Fallon, Associate Director  
401 Reed Lane - Lexington, Kentucky 40503 - 859.381.3474  
www.lafayetteorchestra.org - lhso@mail.com



## Save the date...

**March 24<sup>th</sup> – March 28<sup>th</sup>**

### **Director Visits To Middle Schools**

1. Pass Out Packets
2. Pass Out Audition Music (Level 1-4)

**Thursday, April 11<sup>th</sup>**

### **Freshman Packets are Due to Orchestra Teacher**

1. Student/Family Information Sheet
2. Volunteer Form
3. Audition Registration Form
4. Apparel Order Form/Check: "Lafayette Orchestra Association"

**Wednesday, April 16<sup>th</sup>**

**Viola/Cello/Bass Auditions @ LHS Orchestra Room,  
4:00-6:00pm**

**Thursday, April 17<sup>th</sup>**

**Violin Auditions @ LHS Orchestra Room, 4:00-8:00pm**

**Thursday, May 22<sup>th</sup>**

**LHSO Spring Concert, Singletary Center, 7:00pm**

**July 21<sup>nd</sup> – July 25<sup>th</sup>**

**Freshman Camp @ LHS, 9:00-noon each day**

**Friday, July 25<sup>th</sup> Concert after lunch**



Phil Kent, Orchestra Director- Laura Fallon, Associate Director  
 401 Reed Lane – Lexington, Kentucky 40503 - 859.381.3474  
 www.lafayetteorchestra.org – lhso@mail.com

### Audition Pre-Registration Form



Auditions for LHSO will be held from **3:45-6:00PM** on **Wednesday, April 16<sup>th</sup>** for **Viola, Cello and Bass** and **Thursday, April 17<sup>th</sup>** for **Violins**. Auditions will take place at Lafayette High School in the Music Department. Lafayette High School can be tricky to navigate. Please see the enclosed map for directions. If you are unable to make these audition dates, please notify me at [phil.kent@fayette.kyschools.us](mailto:phil.kent@fayette.kyschools.us) at your earliest convenience. You will be assigned an audition time after this form is submitted. **Please submit this to your orchestra teacher by April 11<sup>th</sup>. The final schedule will be post on the orchestra website.**

Name: \_\_\_\_\_

Instrument: \_\_\_\_\_

Middle School: \_\_\_\_\_

Do you have a specific time preference? Is so what time? \_\_\_\_\_

Level 1    2    3    4    (circle one) Please review the "Orchestra Level 1-4 Summaries"





Phil Kent, Orchestra Director - Laura Fallon, Associate Director  
401 Reed Lane - Lexington, Kentucky 40503 - 859.381.3474  
www.lafayetteorchestra.org - lhso@mail.com

# Orchestra Room Location and Parking

**ORCHESTRA ROOM #623**

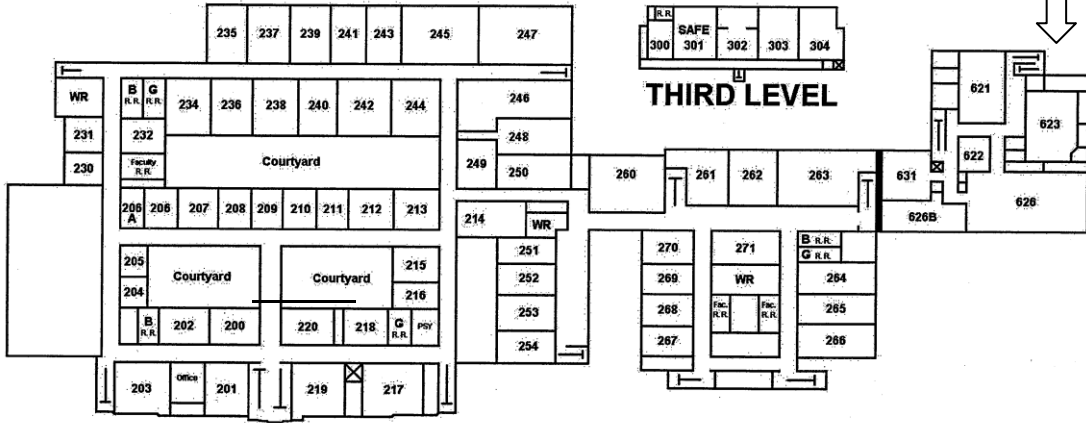

**SECOND LEVEL**

**SPRINGHILL DRIVE**

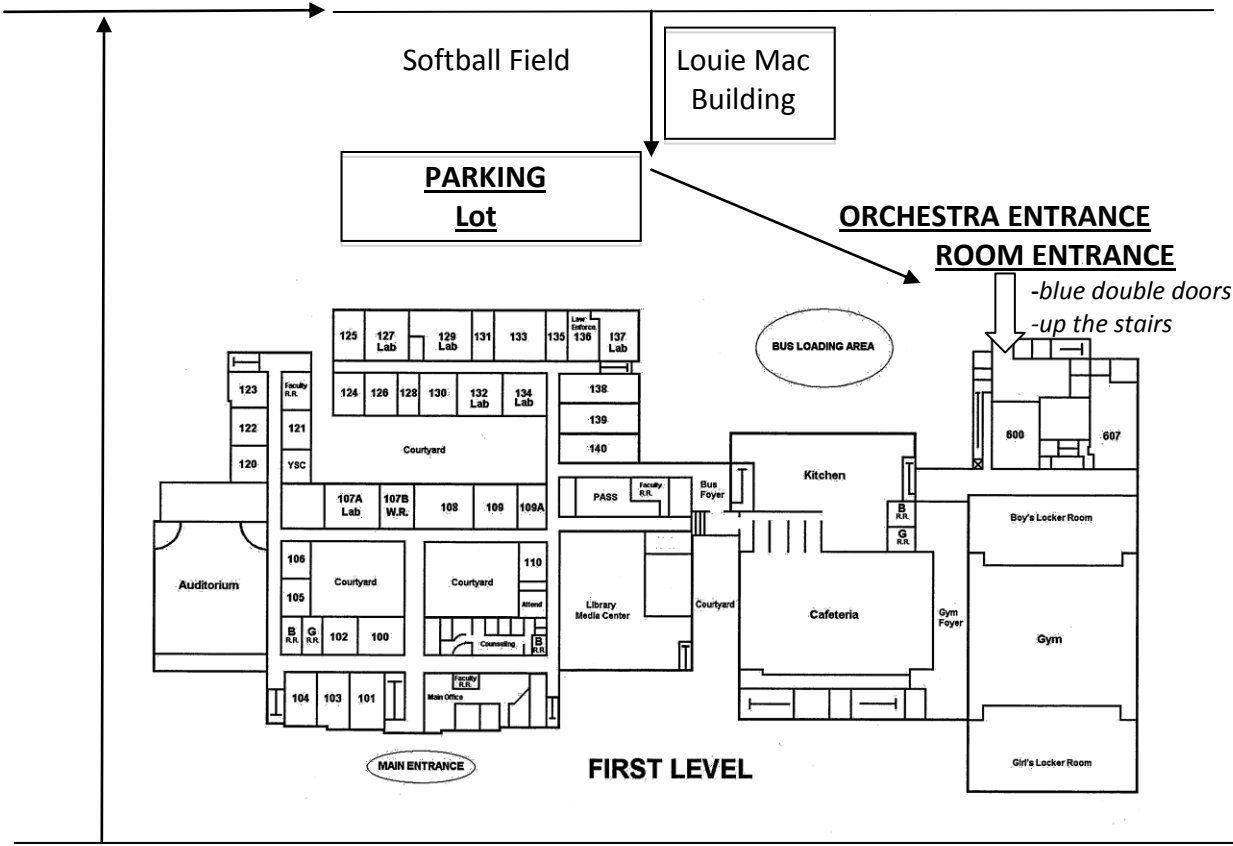

**FIRST LEVEL**

**REED LANE**